

PORTABLE PRESSURE SPRAYER



625773

GENERAL DESCRIPTION

The Magnaflux® Portable Pressure Sprayer is a lightweight pressure sprayer for spot application of penetrants, magnetic particles, developers and cleaners.

INSTRUCTIONS

1. ALWAYS DEPRESSURIZE SPRAYER BEFORE REMOVING ANY PARTS. The pressure may be let out of the sprayer one of the two following ways:
 - a. Tip the sprayer upside down and depress the trigger until no pressure is left. If some liquid is left in the sprayer when you attempt this procedure, make sure you aim the nozzle at a place where a little bit of liquid can be expelled.
 - b. Remove the black cap from air filler and use small probe to depress the valve core until all the pressure escapes. *NOTE: Make sure the sprayer is upright and the air filler stem is pointing away from you when depressing the valve core.*
 - c. Remove the complete top assembly from the canister once all the air has been let out. Do this by grasping the body in one hand and the canister in the other while unscrewing counterclockwise completely.
2. Fill sprayer 2/3 full (24 ounce maximum liquid capacity) with fresh, unused materials. Make sure the material you are putting into the sprayer is CLEAN and FREE OF FOREIGN PARTICLES.
Note: Always check with your chemical supplier if you are not sure of compatibility. Read Caution label on sprayer before filling. NEVER USE ACIDS IN THE SPRAYER.
3. Take the complete top assembly and screw it clockwise into top of the canister. Firmly hand-tighten only.
4. Charge sprayer with compressed air by holding standard air chuck on the air filler until you hear the line pressure equalize with the sprayer. Working pressure is 80-150 psi. At least 80 psi is needed to spray the full 24 oz. without a recharge of air. THE MAXIMUM PRESSURE SHOULD NOT EXCEED 200 PSI.
5. The Portable Pressure Sprayer is now ready to use.

CAUTION: Never point the nozzle of sprayer toward yourself or another person. Always point the nozzle of the sprayer away from yourself and toward your intended target before depressing the trigger.

**ALWAYS DEPRESSURIZE THE SPRAYER BEFORE REMOVING ANY PARTS
 SPRAYER NOT RECOMMENDED FOR USE WITH PAINTS
 MAXIMUM PRESSURE 200 PSI**

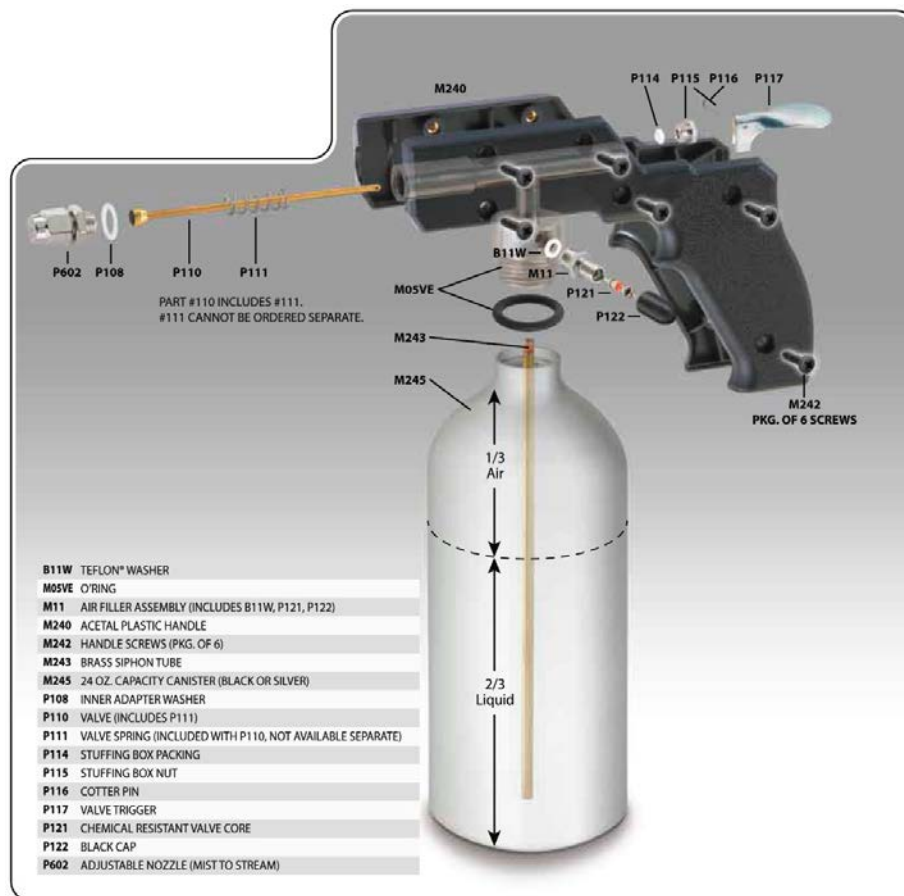

REPAIR PROCEDURES

The following is the correct order and way to remove and replace all the parts on your Portable Pressure Sprayer.

1. ALWAYS DEPRESSURIZE SPRAYER BEFORE REMOVING ANY PARTS. (See page 1)
2. Remove the complete top assembly from the canister once all the air has been let out of the sprayer. Do this by grasping the body in one hand and the canister in the other and unscrewing counterclockwise completely.
3. Use pliers to remove the P116 cotter pin from the P117 trigger and remove the trigger.
4. Remove the P602 nozzle using a 5/8" wrench.
5. Remove the P115 nut using a 3/8" wrench.
6. Remove the P110 valve. Note that the P111 spring is assembled to the P110 valve.

7. You will most likely damage the P114 when you remove it. Be careful not to damage the inside threads when removing the P114. The P114 stuffing box packing may be removed by taking a small thin flat blade screwdriver and working the P114 loose.
8. Remove the B05VE O'Ring from the body.
9. Remove the 7/16" hex M11 air filler assembly from the side of the body. The B11W washer must also be
10. removed and replaced. You have now removed all the parts from the sprayer.
11. To reassemble using your KM10 complete repair kit, start by taking a P114 and placing it into the position you just removed it from. Take the P115 and just hand start the thread.
12. Take the P111 valve spring and assemble it to the P110 valve and place whole assembly into sprayer.
13. Take a P108 washer and assemble to the back of the P602 nozzle. Take the assembly and push the face of the P110 back into the sprayer until you can hand start the thread. Tighten the 5/8" hex until washer is seated.
14. Snug 3/8" hex P115 stuffing box nut. Do not over-tighten.
15. Replace P117 trigger. Line up the holes in the trigger with hole in the back of the P110 valve. Insert
16. P116 cotter pin and using pliers bend over the ends.
17. Press down on the P117 trigger and apply a drop or two of lubricant to the valve stem of the P110 at the rear of the P115 stuffing box nut. Tilt the sprayer so that the lubricant runs into and around the P115.
18. Pressurize sprayer and check for leaks.

CLEANING THE P110 VALVE

1. ALWAYS DEPRESSURIZE SPRAYER BEFORE REMOVING ANY PARTS. (See page 1)
2. Remove the complete top assembly from the canister once all the air has been let out of the sprayer. Do this by grasping the body in one hand and the canister in the other and unscrewing counterclockwise completely.
3. Remove P602 nozzle by using 5/8" wrench on the hex portion of the P602 body. Clean nozzle.
4. The face of the P110 valve is now visible. The face should be clean and clear of all particles. You should see a circular depression caused by the back of the nozzle. This depression should be clean and clear of all debris. You can do this with a small brush.
5. Return P602 nozzle and P108 washer to the opening and tighten.
6. Depress the P117 trigger several times to reset the seal between the face of the P110 valve and the back of the nozzle.
7. Take the top assembly and screw it clockwise into the top of the canister. Firmly hand-tighten only.
8. Pressurize and check for leaks. If valve does not
9. seal correctly, replace the P110 valve.

SPECIFICATIONS COMPLIANCE

ASTM E709-08 (Section 15.1.2)

ASTM E1417/E1417M-13 (Section 7.5.1)

AMS 2647D (Section 3.4.11.5.2)

BPVC (Section V, Article 6: T-675.1)

BPVC (Section V, Article 7: T-773(a))